

NIANTIC BAY YACHT CLUB
2019 Season Dry Sail Storage Application
Deadline April 1, 2019

GENERAL

Members may reserve a dry sail storage space by completing the attached application **Any boat stored on club property shall be registered by completing this application for the current season.** Incomplete forms will not be considered accepted.

Applications must be submitted before bringing boats to the Club. Members bringing their boat to the Club before submitting an application shall be charged the daily fee for storage until an application has been submitted and accepted. The daily fee will be in addition to the annual fee.

The seasonal fee will be invoiced to the member. Payment is due within 30 days from the date of invoice. A penalty of 5% will be charged for each 30 days or part thereof in arrears. Any member with an outstanding balance more than 90 days old is subject to forfeiture of their membership at the discretion of the Board of Governors.

Sailing Dinghies used for sailing lessons are not charged for storage space for their boats if rack stored or half price for ground storage on a trailer/dolly.

All boats/trailers and/or dollies that are stored on NBYC property must be labeled with the member's name. Names should be near the transom of the boat. Trailers/dollies should have the member's name located on the tongue near the hitch or handle. **It is recommended that all parts of the boat be labeled (i.e. rudder, boards, spars, sails, accessories)**

Boat, trailer and any other associated equipment must fit within the marked lines. Spaces are set up so that a Lightning and trailer or similar size boat will fit in the Road Side **(RS)** spaces, 420s or Blue Jay with dolly or trailer will fit in the Water Side **(WS)** spaces. Ensigns or similar keelboats will fit in the Pump House and west end **(PH)** spaces.

Rack Storage is available for Lasers, sailboards, SUP's, kayaks **(LR)**, and Opti's **(OR)**.

Small dinghies, RBI's may be dry stored in the rack **(OR)** without motors or in the water **(IW)** - using dockside space west of the dinghy launching ramp. Dinghies, RBI's stored in the water shall have motor protection (bucket over prop).

The NBYC website and current Yearbook contains Waterfront Regulations and Seasonal Dry Sail Regulations that apply to your application request. Applicants are responsible for reading and following these rules.

LIABILITY

The Niantic Bay Yacht Club assumes no liability for any damage, theft, flooding, or other loss to a member's boat or vessel while in or out of the water at the NBYC facility.

All boats must be insured with liability coverage of \$300,000 minimum. Boats may be required to be removed from club property during storm conditions. You must list phone numbers and emails addresses on your application, so you can be contacted in case of emergency.

Members and their guests are responsible for following all waterfront regulations found in the current yearbook.

OFF SEASON STORAGE

Members may store their boats in the overflow lot next to the pump house after docks out and before docks in provided there is space available. An application and payment must be made before storing a boat. There shall be no sanding, scraping, or painting of boats in the dry sail area.

Complete the 2019 Dry Sail Storage Application for your boat/trailer/dolly to be stored at the Club and
return by **April 1st** to:

Robert Shabunia, P. O. Box 95, North Stonington 06359 or email to **waterfront@nbyc.org**

2019 Seasonal Dry Sail Storage Application

Member's Name * _____
(Please print)

Address * _____

Town * _____ State * _____ Zip * _____

Phone * _____ Cell Phone _____

Email(s) * _____

*Required Field

Storage Space Request (See attached plot map for type and location of spaces)

Fees Subject to 6.35% sales tax and 10% dues tax

OR Space (Opti Rack FEE - \$100.00)

LR Space (Laser Rack FEE - \$100.00)

WS Space (Water Side FEE - \$225.00)

RS Space (Road Side FEE - \$325.00)

PH Space (Pump House FEE - \$500.00)

IW Space (In Water FEE - \$100.00)

Primary Boat to be stored:

Boat Name * _____ Make/Model * _____ Year * _____

Hull/Sail No. * _____ Hull Color * _____ LOA * _____ Beam * _____

Trailer Registration (Lic. Plate #) * _____ State * _____ VIN# _____

Dolly Make/Mfg. * _____ Serial# _____

Boat is to be used for Sailing Lessons (fee reduced by 50% for ground storage, no charge for rack)

Off Season Storage FEE - \$12.00 per foot of boat length (Subject to 6.35% sales tax and 10% dues tax)

Boat Name * _____ Make/Model * _____ Year * _____

Boat LOA * _____ Beam * _____ Total length Boat & trailer * _____

I have read and agree to the current Waterfront Regulations and Dry Sail Area Regulations and this document. I hereby certify that I have insurance coverage on my boat(s) with minimum liability limits of \$300,000 through a boat insurance policy and/or through my homeowners or renters insurance.

Signature * _____ Date: * _____

Dry Sail Area Regulations

1. The dry sail area includes the paved area to the west of the clubhouse and the overflow lot to the east of the pump house. These areas have been lined to create parking spaces that will be available for seasonal rent from the Club. The paved parking area is intended for the storage of sailing dinghies that are primarily used during the summer sailing program. The pump house lot area would be for larger keelboats. The water storage area between the clubhouse and the dinghy dock is also part of the dry sail area for boat storage. **Seasonal storage of boats starts after docks in and end with docks out. Exceptions can be made for winter sailing.**
2. There are three sizes of ground spaces to accommodate the different fleets of boats at the Club.
 - a. The spaces along the waterside **(WS)** of the parking lot are 7ft. wide by 18ft. long for, 420's on dollies, Optimists on dollies, Lasers on dollies and any other sailboat that is in this size range.
 - b. The spaces that back up to the road **(RS)** are 9ft. wide by 20ft. long and will accommodate Lightning's and other similar size sailboats.
 - c. The largest spaces available are at the west end of the paved parking lot and along the east side of the overflow lot **(PH)**. These spaces are 10ft. wide by 22ft. long, Ensigns and similar size keelboats on trailers will fit these spaces.
 - d. Rack storage is available in both the Opti rack **(OR)** and the Laser rack **(LR)**.
3. Water storage **(IW)** will continue to be available west of the dinghy dock for tenders, inflatables and RIB's not to exceed 12 feet LOA. Boats stored in water west of the dinghy dock with outboard motors attached shall provide propeller protection for other boats in the area (5 gal. bucket over the prop).
4. All boats in the dry sail area must be registered with the Waterfront Chairman. **Complete a separate application for each boat that will be stored in the Dry Sail area.** Once a space has been assigned to a member all efforts will be made to continue to reassign the space to the member as long as a renewal application is received each year before the deadline for applying. Late renewal may result in reassigning to a different space.
5. **All boats/trailers and/or dollies that are stored on NBYC property shall be labeled with the member's name.**
6. There will be no restriction on the number of boats that can be kept in a space, however the sailboat(s) must fit within the lines of the rental space. **If more than one boat is to be stored in a single dry sail space, then list all boats on one application and the primary boat to use the space.**
7. Powerboats used in support of the sailing program may be stored in a rental space and charged the appropriate fee. They must be on a dolly or trailer and must fit within the parking space.
8. Temporary storage of a powerboat on club property may be permitted for use during a regatta or other special event. Approval by the Flag Officers and/or the Board of Governors must be obtained for the temporary storage of a powerboat on Club property and posted in the office before the boat can be brought onto club property.
9. "Hot Bunking" – Temporary storage of a sailboat in the dry sail area if a space is available and the boat fit within the designated space. The member shall be charged a daily fee for the "hot bunking." Any boat found in a space not assigned will be considered "hot bunked" and a fee will be assessed of the member.
10. Off-season storage of member's boats in the pump house lot is permitted provided there is space available.
 - a. The member shall complete an application and prepay the fee before bringing a boat to the club.
 - b. Off-season storage starts after docks out and boats shall be removed before docks in.
 - c. All boats stored on NBYC property shall be labeled with the member's name.

- d. The boat being stored shall be on a trailer or dolly that can be moved easily if it is in the way of work that may be done in the area.
- e. The club assumes no responsibility for the boat during its storage at the club. The member shall maintain insurance on the boat for the time it is on club property.
- f. There shall be no sanding, scraping, or painting of boats in the dry sail area.

Waterfront Regulations

1. The Niantic Bay Yacht Club assumes no liability for any damage, theft, flooding, or other loss to a member's boat or vessel while in or out of the water at the NBYC facility.
2. Members and their guests using the waterfront facilities do so at their own risk and shall exercise due care to prevent accidents or damage to boats, docks and equipment.
3. Electrical outlets on the docks and breakwater are for the temporary use of small appliances or tools only. The electrical service is not rated for shore power. Power cords are not to be left plugged in overnight and will be removed if found.
4. Open fires on boats or docks are prohibited.
5. Running, bike riding, skateboarding, rollerblading and horseplay are prohibited on the docks, breakwater, and other waterfront facilities.
6. Fishing is permitted only on the outside of the breakwater. Fishing is not permitted from the breakwater in the swimming area.
7. The end of the T-dock is to be used only for temporarily tie-ups to load or unload passengers and gear, or for short duration repairs or alterations. Such use should be kept to a minimum and the boat must be attended. During Club sponsored regattas the T-dock must be kept open for the use of regatta participants.
8. The crane and electric hoists are to be used only by personnel who have been instructed and qualified in the proper operation of the equipment.
9. Boarding any vessel without the owner's permission is prohibited except in the case of an emergency.
10. Employees and Club members may use the club power boats only if they are 16 or older, have a Connecticut Safe Boater Certificate and have been instructed in the safe operation of the boat. The Club Manager shall be notified if a Club boat is to travel beyond the immediate area of Niantic Bay out of site of the Club.
11. Owners of stored boats, both dry sail and slips, must have liability insurance with a minimum limit of \$300,000. Vessels must maintain current Connecticut boating registration as required.
12. All slip holders shall submit a copy of their boat's registration and proof of insurance with the Club Manager upon arrival at the Club.
13. Slip holders must provide and use their own lines, chafing gear and fenders and shall properly maintain such equipment. In the event of storms, slip holder shall check on their vessels, applying chafing gear, doubling up or add extra mooring lines and making sure their boat is closed up with loose gear stowed. It is the responsibility of the slip holder to arrange for someone to perform these tasks if the slip holder cannot do so. Slip holders are responsible to prevent damage to their boat, neighboring boats and docks.
14. All boats are to be operated in a safe and prudent manner. The mooring field and breakwater basin are a "no wake" speed area.
15. If a significant storm is forecast it is recommended that boats be moved to more suitable shelter than the club docks. In the event of a major storm and/or hurricane owners may be required to remove their vessels from the Club docks and property at the direction of the Flag Officers and/or Waterfront Chairman. All boat owners SHALL leave contact information with the club and make himself /herself or a representative available to move their boat(s) if so directed. Failure to remove your vessel will result in the member being charged for the damage caused by their vessel to club property.
16. It is expected that all who use the waterfront facilities be cooperative; lending a hand when required; be considerate of others; keep the areas clean and ship shape; tie off halyards, coil lines and hoses; and be especially careful with electric cables.
17. Unsafe conditions or the failure of gear must be reported immediately, and boat owners are expected to adhere to the traditions of yachting and the sea.

MHW (EL.=1.8±)

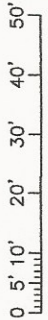

1	4	7	10	13	16	19	22
2	5	8	11	14	17	20	23
3	6	9	12	15	18	21	24

OPTI RACKS

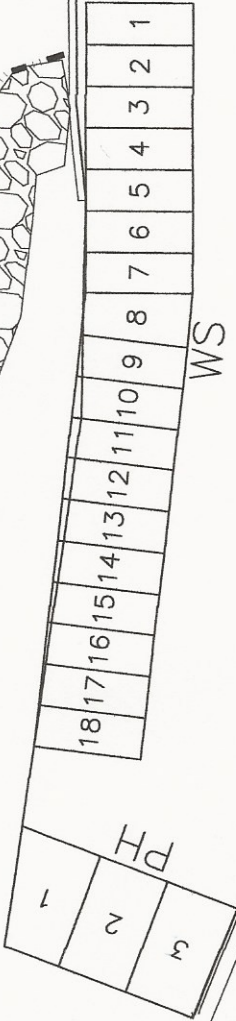

WS

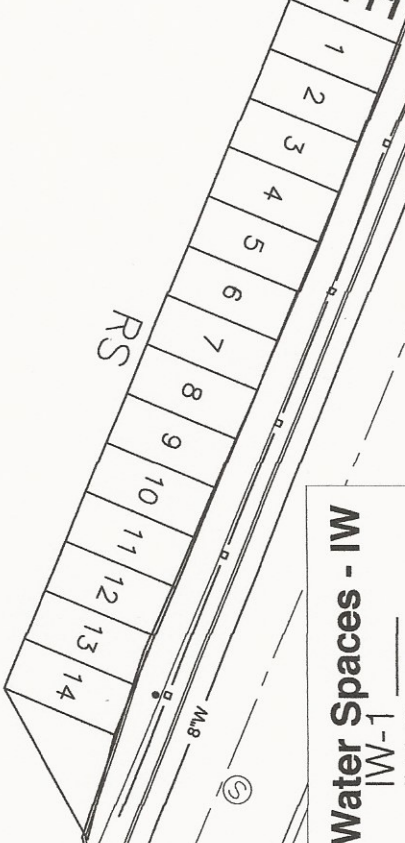

RS



LASERS

In Water Spaces - IW

IW-1	_____
IW-2	_____
IW-3	_____
IW-4	_____
IW-5	_____
IW-6	_____
IW-7	_____
IW-8	_____
IW-9	_____
IW-10	_____
IW-11	_____
IW-12	_____

PARKING LOT